

## Description

### Standard Features :

- Manual Locking System
- Mechanical Diameter Scale Indicator
- Hydraulic Height Adjustment by Handle.
- Polyurethane Coated Rollers
- One «1» idler unit.
- Standard Machine Colors:
  - Chassis RAL 7011(Grey)
  - Sheet Covers:RAL 3002(Red)
- One «1» Year Warranty  
(wearing parts are out of warranty)



## General Features :

- BHML Adjustable diameter Hydraulic Manual Lift is designed as a suitable solution to qualified and proper circumferential welding of cylindrical parts according to requested diameter settings at suitable certain capacities..
- BHML Adjustable diameter Hydraulic Manual Lift minimizes the usage of crane and by easier usage provides saving of time.
- In Pipe welding production , it has an irreplaceable design in centering between Head and Tailstock distances it has an irreplaceable design
- Although BHML adjustable diameter Hydraulic Manual Lift is constituted of single idler unit, If easy movement over a rail arrangement by means of a manual buggy system is requested, By increasing the number of BHML, we can easily provide positioning to more longer parts .
- BHML model adjustable diameter Hydraulic Manual Lift is produced as standard 3000kg. According to special diameter & load range, we present special customer design production.

### Technical Details :

Model : BHML	Sym	Unit	BHML-3
Load Capacity		kg	3000
Min.-Max.Diameter	∅Dmin-∅Dmax	mm	50 – 1250
Height	H1-H2	mm	1065-1200
Rail Axis	E	mm	770
Width	A	mm	885
Length	B	mm	670
Weight		kg	320

↪ Out of these std. capacities, Birel Machinery, according to customer requirements has the manufacturing possibility at different capacities, sizes.

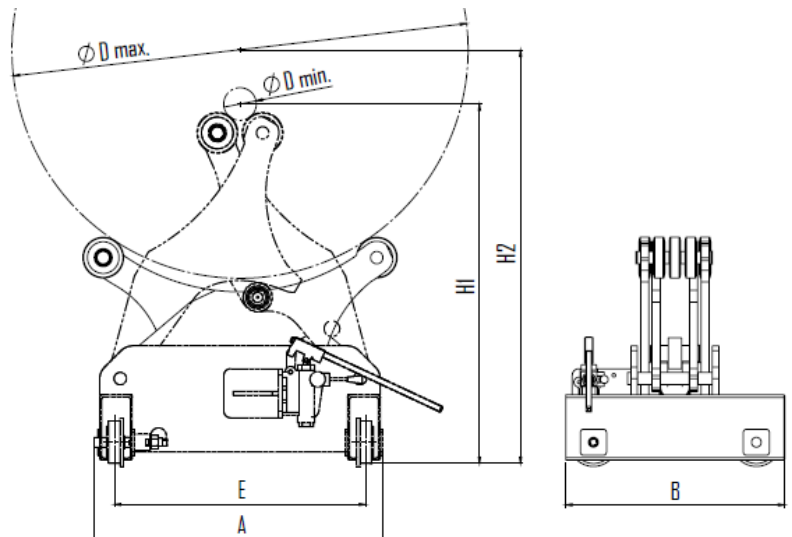

❖ All technical specifications are subject to change without prior notice.